

# MAXIMIZE

↕ Space    ⌚ Time    💰 Money



Drawer Systems and Storage Solutions



ORGANIZATION MADE EASY™

Did you know 95% of a records activity occurs within the first 2-3 years?



# Did You Know?

- Drawers can save you up to 50% of storage space and increase storage capacity up to 80%
- Drawers allow easier access to your documents by eliminating stacking and restacking boxes
- On-site records storage saves time by giving you instant file access
- On-site storage reduces handling of your records and increases control of who has access to your files. In an era of data breaches, have peace of mind knowing who is looking at your information

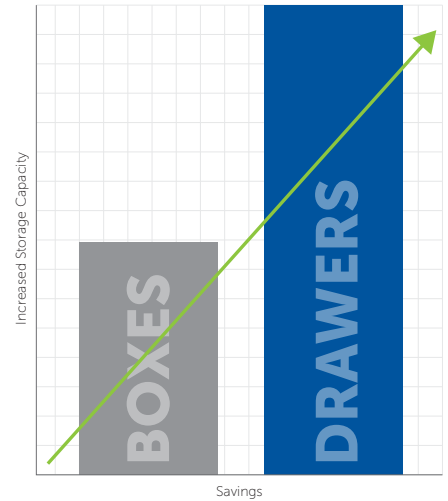

## When Are Drawers the Right Solution?

Drawers are ideal when you have a limited amount of storage space - no shelving units - and require frequent access to files. The stronger the drawers, the higher they stack, and the more you save.

Space is Limited

Files are Frequently Accessed

Need the Ability to Expand



## Choosing the Right Storage Drawer System

### Drawer Space-Savings

Consider storage efficiency and frequency of access.

<b>Maximum</b> Space-Savings	Frequent Access
<b>Extra</b> Space-Savings	Occasional Access
<b>Basic</b> Space-Savings	Infrequent Access

### Drawer Stackability

The higher a drawer system stacks the more space, time and money you can save.

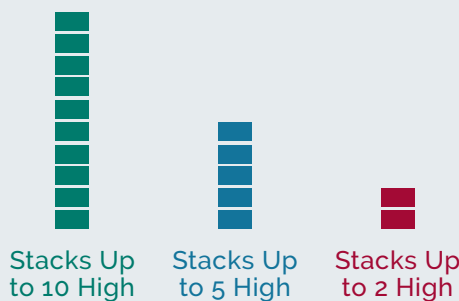

### Document Size

Do you plan on storing letter or legal size documents?

<p><b>Letter Size</b> 8.5" x 11"</p>	<p><b>Legal Size</b> 8.5" x 14"</p>
--	---

# Compare Boxes to Drawers

Stacking boxes not only makes accessing records more difficult and time consuming, it's also more expensive and takes up significantly more space. Compare StaxOnSteel® Storage Drawers to standard letter/legal boxes.

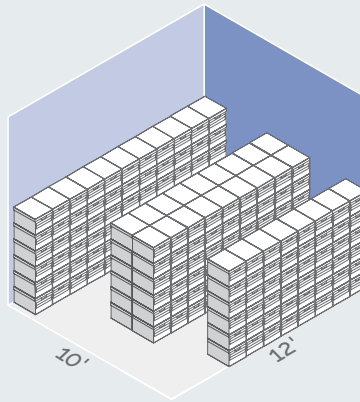

Letter/Legal Storage Boxes

- 37 stacks at 6 boxes high
- Storage Space: 231.25 cubic feet



StaxOnSteel® Storage Drawers

- 25 stacks at 10 drawers high
- Storage Space: **416.67 cubic feet**

vs.

## STAXONSTEEL®

### MAXIMUM SPACE-SAVING

#### A DRAWERS

- **Stacks 10 high – Store 80% more records in the same floor space**
- Steel framework interlocks vertically and horizontally to withstand the heaviest day-to-day usage
- Steel stacker bars won't buckle, twist or bend and offer space-saving stackability with the accessibility of a filing cabinet
- Our strongest system is also the easiest to assemble. Drawers snap together with poly-lock technology and are reinforced with steel wire
- Steel frame and reinforced panels ensure drawers fully open and close smoothly
- Factory installed, high-impact drawer handle with index card holder for fast file retrieval (index cards included)
- Available in letter size (00511) or legal size (00512)

#### B METAL BASES

- Protect your files by raising them 2.5" above floor level
- Helps prevent damage from kicks, cleaning equipment and moisture



Maximum Space-Savings

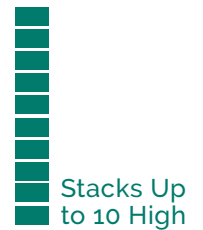

**STAX ON STEEL®**  
It Builds Its Own Steel Framework!



Item #	Size	Inside Dimensions (H x W x D)	Stacking Height	Color		Carton Quantity
A. FEL-00511	Letter	10½" x 12" x 24"	10	Black	60%	6
FEL-00512	Legal	10½" x 15" x 24"	10	Black	60%	6
B. FEL-12602	Letter (511)	2½" x 13⅞" x 25⅜"	N/A	Black	N/A	1 Ea.
FEL-15602	Legal (512)	2½" x 16⅞" x 25⅜"	N/A	Black	N/A	1 Ea.

# STOR/DRAWER® STEEL PLUS™

## EXTRA SPACE-SAVING

- **Stacks 5 high** – The higher the drawer system stacks, the more space, time and money you save
- Heavy wire frame provides strength and stability. Four layer front and back panel construction holds up to daily usage (excluding FEL-00302 and FEL-00306)
- Includes removable rails for hanging files (excluding FEL-00302 & FEL-00306)
- Reinforced plastic handle for easy drawer access
- Available in letter size (00311) or legal size (00312)



Extra Space-Savings

Stacks Up to 5 High



Item #	Size	Inside Dimensions (H x W x D)	Stacking Height	Color		Carton Quantity
FEL-00302	Check	4 <sup>3</sup> / <sub>8</sub> " x 9 <sup>1</sup> / <sub>4</sub> " x 23 <sup>1</sup> / <sub>4</sub> "	5	White/Blue	60%	12
FEL-00306	5" x 8"	5 <sup>5</sup> / <sub>8</sub> " x 9 <sup>1</sup> / <sub>4</sub> " x 23 <sup>1</sup> / <sub>4</sub> "	5	White/Blue	60%	12
FEL-00311	Letter	10 <sup>3</sup> / <sub>8</sub> " x 12 <sup>1</sup> / <sub>2</sub> " x 23 <sup>1</sup> / <sub>4</sub> "	5	White/Blue	60%	6
FEL-00312	Legal	10 <sup>3</sup> / <sub>8</sub> " x 15 <sup>1</sup> / <sub>2</sub> " x 23 <sup>1</sup> / <sub>4</sub> "	5	White/Blue	60%	6
FEL-1231101	Letter	10 <sup>3</sup> / <sub>8</sub> " x 12 <sup>1</sup> / <sub>2</sub> " x 23 <sup>1</sup> / <sub>4</sub> "	5	Kraft/Green	100%	6
FEL-1231201	Legal	10 <sup>3</sup> / <sub>8</sub> " x 15 <sup>1</sup> / <sub>2</sub> " x 23 <sup>1</sup> / <sub>4</sub> "	5	Kraft/Green	100%	6

# STAX CUBES

## EXTRA SPACE-SAVING

- **Stacks 7 high** – To save floor space
- Interlocking steel framework stacks vertically and horizontally
- Each cube holds two letter/legal boxes or one 24" letter-size box with lid (boxes not included)
- Insert boxes from either front or back of Stax Cube
- Retrieve any box instantly without moving other boxes
- 00524 – Make to order only



Extra Space-Savings

Stacks Up to 5 High

Item #	Size	Inside Dimensions (H x W x D)	Stacking Height	Color		Carton Quantity
FEL-00524	Ltr/Lgl or 24" Boxes	11 <sup>1</sup> / <sub>4</sub> " x 13 <sup>3</sup> / <sub>4</sub> " x 33"	7	White/Blue	60%	6

## FILE/CUBE™ Box Shell

### EXTRA SPACE-SAVING

- **Stacks 5 high** – to save floor space
- Keeps your letter/legal boxes accessible during temporary storage or for long-term projects
- Eliminates the need to stack and restack boxes
- Modular shells with steel supports
- Durable shells clip together vertically and horizontally for stability
- Features Quick Set-Up assembly



**Extra**  
Space-Savings

**Stacks Up**  
to 5 High

Item #	Size	Inside Dimensions (H x W x D)	Stacking Height	Color		Carton Quantity
FEL-0162601	Letter/Legal Shells Only	10" x 12" x 15"	5	White/Blue	60%	6

## STOR/DRAWER®

### BASIC SPACE-SAVING

- **Stacks 2 high**
- Reinforced front and back drawer panels for lasting strength
- Multi-wall thickness on drawer sides and back improves durability
- Reinforced plastic handle for easy drawer access



**Basic**  
Space-Savings

**Stacks Up**  
to 2 High

Item #	Size	Inside Dimensions (H x W x D)	Stacking Height	Color		Carton Quantity
FEL-00721	Letter	10 <sup>3</sup> / <sub>8</sub> " x 12 <sup>1</sup> / <sub>2</sub> " x 23 <sup>3</sup> / <sub>4</sub> "	2	White/Blue	60%	6
FEL-00722	Legal	10 <sup>3</sup> / <sub>8</sub> " x 15 <sup>1</sup> / <sub>2</sub> " x 23 <sup>3</sup> / <sub>4</sub> "	2	White/Blue	60%	6
FEL-00211	Letter	10 <sup>3</sup> / <sub>8</sub> " x 12 <sup>1</sup> / <sub>2</sub> " x 23 <sup>3</sup> / <sub>4</sub> "	2	Kraft/Green	100%	6
FEL-00212	Legal	10 <sup>3</sup> / <sub>8</sub> " x 15 <sup>1</sup> / <sub>2</sub> " x 23 <sup>3</sup> / <sub>4</sub> "	2	Kraft/Green	100%	6

# FREE Records Room Custom Layout

Tired of caved-in, messy boxes, shrinking storage space,  
and lengthy file searches? **We Can Help!**

Call **1-800-955-0959** or fill out  
the form and e-mail it to: [bankersbox@fellowes.com](mailto:bankersbox@fellowes.com)



# Records Room Layout Instructions

Use the below graph to prepare a rough sketch of your customers records room. Please include the dimensions of every wall. In addition, please consider the potential obstacles on the left and add these to the drawing if they impact the layout of records. Please note that all aisle ways are required to be at least 3 feet in width.

Rep Name \_\_\_\_\_

Customer Name \_\_\_\_\_

Customer Phone \_\_\_\_\_

Customer eMail \_\_\_\_\_

Product Proposed \_\_\_\_\_

Exterior Wall (ft, in) 1. \_\_\_\_\_ 2. \_\_\_\_\_ 3. \_\_\_\_\_ 4. \_\_\_\_\_

Usable Ceiling Height \_\_\_\_\_ ft. \_\_\_\_\_ in.

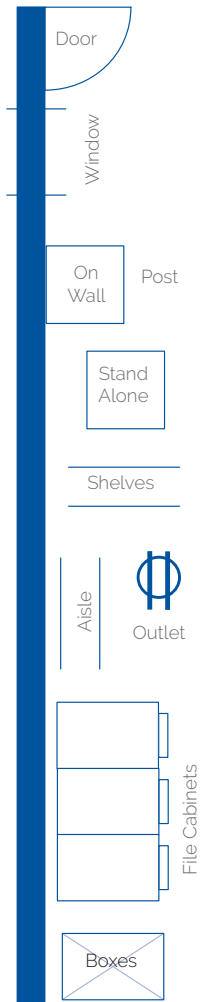

## Check List

### Room Size

- Do you have the measurements of all the exterior walls
- If there is an angled (not rectangular) wall please include an angle if possible and a measurement from the end of the wall to a far corner
- Did you include the dimensions of a door that may interfere with the records?
- Are there outlets, phone jacks, or other objects that the customer may need access to?

### Usable Ceiling Height

- Do you have the measurements of all the exterior walls
- If there is an angled (not rectangular) wall please include an angle if possible and a measurement from the end of the wall to a far corner
- Did you include the dimensions of a door that may interfere with the records?
- Are there outlets, phone jacks, or other objects that the customer may need access to?

Examples of filled out records room layouts:

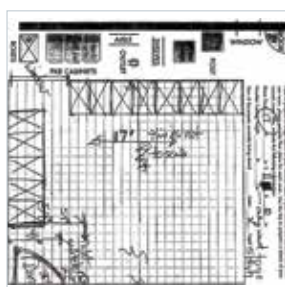
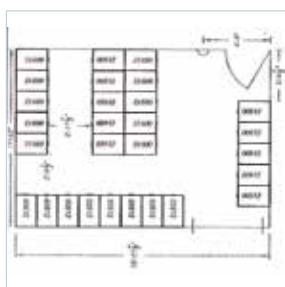

Fellowes, Inc.  
 Attn: BANKERS BOX®  
 1789 Norwood Avenue  
 Itasca, Illinois 60143-1095  
 Fax number: 630-539-1637  
 E-mail: bankersbox@fellowes.com



ORGANIZATION MADE EASY™



To contact a Fellowes® service representative,  
call 1-800-955-0959 or visit us on the web at  
[www.bankersbox.com](http://www.bankersbox.com)

© 2018 Fellowes, Inc. | Form #604

Bankers Box® is a registered trademark of Fellowes, Inc.